

# SCREWS



Cement Board  
Screws



DRYWALL  
SCREWS



Metal Building  
Screws



CONCRETE  
SCREWS



BENNER  
PRODUCTS

# SCREWS CHARACTERISTICS

## HEADS STYLES

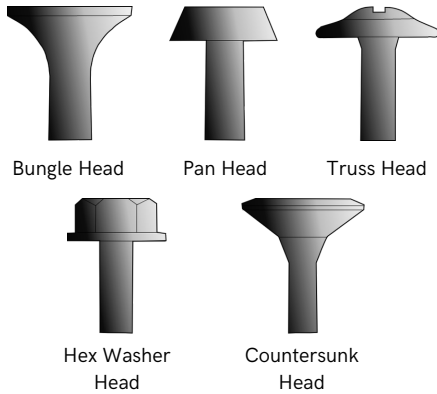

## POINT STYLES

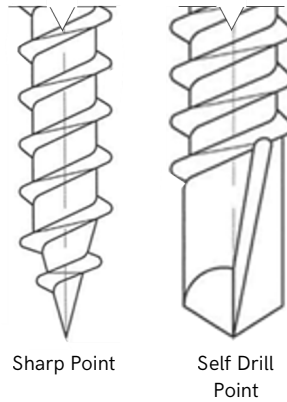

## THREAD STYLES

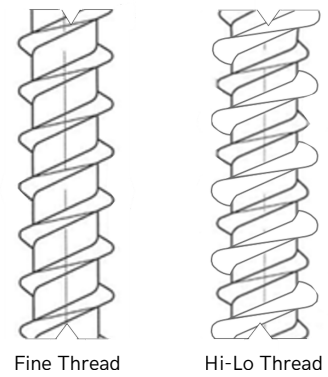

# CEMENT BOARD SCREW

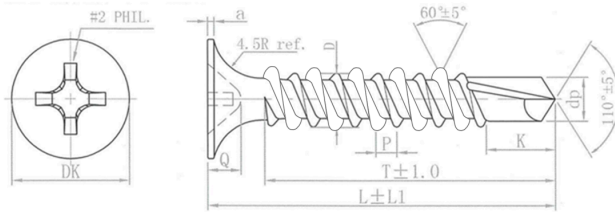

Finish	Color	For Use On (Material)	Corrosion Resistance
Zinc (electroplated)	White & Zinc Plated	All metals	Good
Phosphate	Black	Metal Stud Gypsum Board Wood Compose Panel	Very Good
Ceramic	Grey	Gutters Metal Roofs Wood Compose Panel	Excellent

Commercial Code	Name	Size	Head Drives	Head	Thread	Coated	Point	Screw Color	Packaging	MOQ
5626	Screw #9 - 1-1/4" Grey	#9 x 1-1/4"	Phillips	Countersunk	Hi-Lo	Ceramic	Self Drill	Grey	1lb	100
5626-5	Screw #9 - 1-1/4" Grey	#9 x 1-1/4"	Phillips	Countersunk	Hi-Lo	Ceramic	Self Drill	Grey	5lb	50
5626-25	Screw #9 - 1-1/4" Grey	#9 x 1-1/4"	Phillips	Countersunk	Hi-Lo	Ceramic	Self Drill	Grey	25lb	50

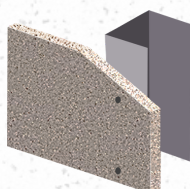

Board to Frame

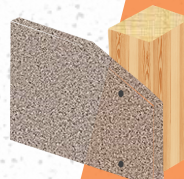

Board to Wood

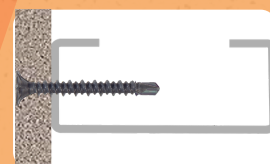

# DRYWALL SCREWS

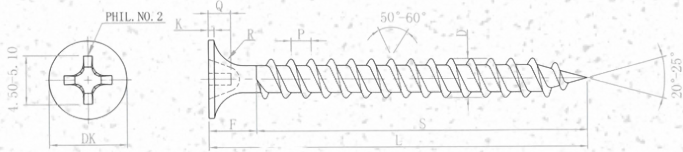

Finish	Color	For Use On (Material)	Corrosion Resistance
Zinc (electroplated)	White & Zinc Plated	All metals	Good
Phosphate	Black	Metal Stud Gypsum Board Wood Compose Panel	Very Good
Ceramic	Grey	Gutters Metal Roofs Wood Compose Panel	Excellent

Commercial Code	Name	Size	Head Drives	Head	Thread	Coated	Point	Screw Color	Packaging	MOQ
5614	Screw #6 - 1-1/4" - Black	#6 x 1-1/4"	Phillips	Bugle head	Fine	Phosphate	Sharp	Black	1lb	100
5612	Screw #6 - 1-5/8" - Black	#6 x 1-5/8"	Phillips	Bugle head	Fine	Phosphate	Sharp	Black	1lb	100
5620	Screw #8 - 2-1/4" - Black	#8 x 2-1/4"	Phillips	Bugle head	Fine	Phosphate	Sharp	Black	1lb	100
5622	Screw #8 - 2-5/8" - Black	#8 x 2-5/8"	Phillips	Bugle head	Fine	Phosphate	Sharp	Black	1lb	100
5624	Screw #8 - 3-1/4" - Black	#8 x 3-1/4"	Phillips	Bugle head	Fine	Phosphate	Sharp	Black	1lb	100
5614-5	Screw #6 - 1-1/4" - Black	#6 x 1-1/4"	Phillips	Bugle head	Fine	Phosphate	Sharp	Black	5lb	50
5612-5	Screw #6 - 1-5/8" - Black	#6 x 1-5/8"	Phillips	Bugle head	Fine	Phosphate	Sharp	Black	5lb	50
5620-5	Screw #8 - 2-1/4" - Black	#8 x 2-1/4"	Phillips	Bugle head	Fine	Phosphate	Sharp	Black	5lb	50
5622-5	Screw #8 - 2-5/8" - Black	#8 x 2-5/8"	Phillips	Bugle head	Fine	Phosphate	Sharp	Black	5lb	50
5624-5	Screw #8 - 3-1/4" - Black	#8 x 3-1/4"	Phillips	Bugle head	Fine	Phosphate	Sharp	Black	5lb	50
5614-25	Screw #6 - 1-1/4" - Black	#6 x 1-1/4"	Phillips	Bugle head	Fine	Phosphate	Sharp	Black	25lb	50
5612-25	Screw #6 - 1-5/8" - Black	#6 x 1-5/8"	Phillips	Bugle head	Fine	Phosphate	Sharp	Black	25lb	50
5620-25	Screw #8 - 2-1/4" - Black	#8 x 2-1/4"	Phillips	Bugle head	Fine	Phosphate	Sharp	Black	25lb	50
5622-25	Screw #8 - 2-5/8" - Black	#8 x 2-5/8"	Phillips	Bugle head	Fine	Phosphate	Sharp	Black	25lb	50
5624-25	Screw #8 - 3-1/4" - Black	#8 x 3-1/4"	Phillips	Bugle head	Fine	Phosphate	Sharp	Black	25lb	50

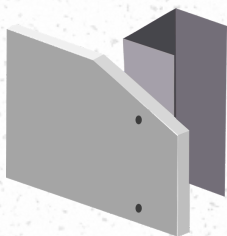

Board to Frame

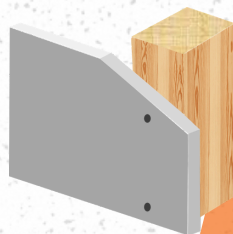

Board to Wood

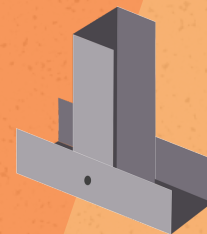

Frame to Frame



# DRYWALL SCREWS

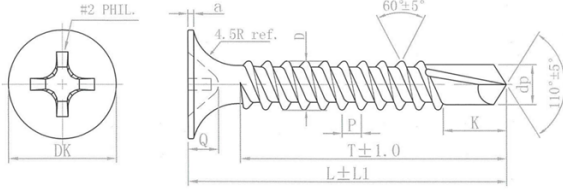

Finish	Color	For Use On (Material)	Corrosion Resistance
Zinc (electroplated)	White & Zinc Plated	All metals	Good
Phosphate	Black	Metal Stud Gypsum Board Wood Compose Panel	Very Good
Ceramic	Grey	Gutters Metal Roofs Wood Compose Panel	Excellent

Commercial Code	Name	Size	Head Drives	Head	Thread	Coated	Point	Screw Color	Packaging	MOQ
5613	Screw#6 - 1-5/8" - Zinc Plated	#6 x 1-5/8"	Phillips	Bugle head	Fine	Zinc Plated	Self Drill	Zinc	1lb	100
5615	Screw #6 - 1-1/4" Zinc Plated	#6 x 1-1/4"	Phillips	Bugle head	Fine	Zinc Plated	Self Drill	Zinc	1lb	100
5621	Screw #8 - 2-1/4" Zinc	#8 x 2-1/4"	Phillips	Bugle head	Fine	Zinc Plated	Self Drill	Zinc	1lb	100
5623	Screw #8 - 2-5/8" Zinc	#8 x 2-5/8"	Phillips	Bugle head	Fine	Zinc Plated	Self Drill	Zinc	1lb	100
5625	Screw #8 - 3-1/4" - Zinc	#8 x 3-1/4"	Phillips	Bugle head	Fine	Zinc Plated	Self Drill	Zinc	1lb	100
5613-5	Screw#6 - 1-5/8" - Zinc Plated	#6 x 1-5/8"	Phillips	Bugle head	Fine	Zinc Plated	Self Drill	Zinc	5lb	50
5615-5	Screw #6 - 1-1/4" Zinc Plated	#6 x 1-1/4"	Phillips	Bugle head	Fine	Zinc Plated	Self Drill	Zinc	5lb	50
5621-5	Screw #8 - 2-1/4" Zinc	#8 x 2-1/4"	Phillips	Bugle head	Fine	Zinc Plated	Self Drill	Zinc	5lb	50
5623-5	Screw #8 - 2-5/8" Zinc	#8 x 2-5/8"	Phillips	Bugle head	Fine	Zinc Plated	Self Drill	Zinc	5lb	50
5625-5	Screw #8 - 3-1/4" - Zinc	#8 x 3-1/4"	Phillips	Bugle head	Fine	Zinc Plated	Self Drill	Zinc	5lb	50
5613-25	Screw#6 - 1-5/8" - Zinc Plated	#6 x 1-5/8"	Phillips	Bugle head	Fine	Zinc Plated	Self Drill	Zinc	25lb	50
5615-25	Screw #6 - 1-1/4" Zinc Plated	#6 x 1-1/4"	Phillips	Bugle head	Fine	Zinc Plated	Self Drill	Zinc	25lb	50
5621-25	Screw #8 - 2-1/4" Zinc	#8 x 2-1/4"	Phillips	Bugle head	Fine	Zinc Plated	Self Drill	Zinc	25lb	50
5623-25	Screw #8 - 2-5/8" Zinc	#8 x 2-5/8"	Phillips	Bugle head	Fine	Zinc Plated	Self Drill	Zinc	25lb	50
5625-25	Screw #8 - 3-1/4" - Zinc	#8 x 3-1/4"	Phillips	Bugle head	Fine	Zinc Plated	Self Drill	Zinc	25lb	50

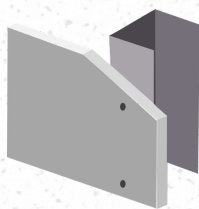

Board to Frame

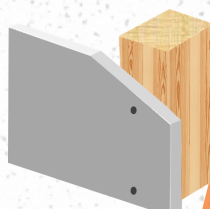

Board to Wood

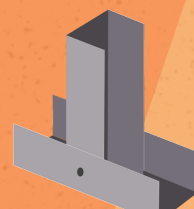

Frame to Frame



# METAL BUILDING SCREWS



Code 5616



Code 5617



Code 5647



Code 5618



Code 5619

Finish	Color	For Use On (Material)	Corrosion Resistance
Zinc (electroplated)	White & Zinc Plated	All metals	Good
Phosphate	Black	Metal Stud Gypsum Board Wood Compose Panel	Very Good
Ceramic	Grey	Gutters Metal Roofs Wood Compose Panel	Excellent

Commercial Code	Name	Size	Head Drives	Head	Thread	Coated	Point	Screw Color	Packaging	MOQ
5616	Screw #7 - 7/16" - Zinc	#7 x 7/16"	Phillips	Pan head	Fine	Zinc Plated	Self Drill	Zinc	1lb	100
5617	Screw #7 - 7/16" - Black	#7 x 7/16"	Phillips	Pan head	Fine	Phosphate	Sharp	Black	1lb	100
5647	Screw #7 - 7/16" - Zinc	#7 x 7/16"	Phillips	Pan head	Fine	Zinc Plated	Sharp	Zinc	1lb	100
5618	Screw #8 - 1/2" - Zinc	#8 x 1/2"	Phillips	Truss head	Fine	Zinc Plated	Self Drill	Zinc	1lb	100
5619	Screw #8 - 1/2" - Black	#8 x 1/2"	Phillips	Truss head	Fine	Phosphate	Sharp	Black	1lb	100
5616-5	Screw #7 - 7/16" - Zinc	#7 x 7/16"	Phillips	Pan head	Fine	Zinc Plated	Self Drill	Zinc	5lb	50
5617-5	Screw #7 - 7/16" - Black	#7 x 7/16"	Phillips	Pan head	Fine	Phosphate	Sharp	Black	5lb	50
5647-5	Screw #7 - 7/16" - Zinc	#7 x 7/16"	Phillips	Pan head	Fine	Zinc Plated	Sharp	Zinc	5lb	50
5618-5	Screw #8 - 1/2" - Zinc	#8 x 1/2"	Phillips	Truss head	Fine	Zinc Plated	Self Drill	Zinc	5lb	50
5619-5	Screw #8 - 1/2" - Black	#8 x 1/2"	Phillips	Truss head	Fine	Phosphate	Sharp	Black	5lb	50
5616-25	Screw #7 - 7/16" - Zinc	#7 x 7/16"	Phillips	Pan head	Fine	Zinc Plated	Self Drill	Zinc	25lb	50
5617-25	Screw #7 - 7/16" - Black	#7 x 7/16"	Phillips	Pan head	Fine	Phosphate	Sharp	Black	25lb	50
5647-25	Screw #7 - 7/16" - Zinc	#7 x 7/16"	Phillips	Pan head	Fine	Zinc Plated	Sharp	Zinc	25lb	50
5618-25	Screw #8 - 1/2" - Zinc	#8 x 1/2"	Phillips	Truss head	Fine	Zinc Plated	Self Drill	Zinc	25lb	50
5619-25	Screw #8 - 1/2" - Black	#8 x 1/2"	Phillips	Truss head	Fine	Phosphate	Sharp	Black	25lb	50

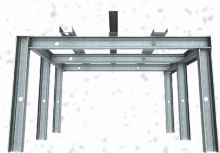

Metal Building



Board to Frame

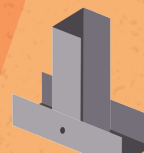

Frame to Frame



# CONCRETE SCREWS

Finish	Color	For Use On (Material)	Corrosion Resistance
Zinc (electroplated)	White & Zinc Plated	All metals	Good
Phosphate	Black	Metal Stud Gypsum Board Wood Composite Panel	Very Good
Ceramic	Grey	Gutters Metal Roofs Wood Composite Panel	Excellent

Commercial Code	Name	Size	Head Drives	Head	Thread	Coated	Point	Screw Color	Packaging	MOQ
5627	HX Screw 1/4" x 1-1/4" - White	1/4" x 1-1/4"	Slotted Hex	Hex Washer	Hi-Lo	White zinc plated	Sharp	White	1lb	100
5628	HX Screw 1/4" x 1-3/4" - White	1/4" x 1-3/4"	Slotted Hex	Hex Washer	Hi-Lo	White zinc plated	Sharp	White	1lb	100
5629	HX Screw 1/4" x 2-1/4" - White	1/4" x 2-1/4"	Slotted Hex	Hex Washer	Hi-Lo	White zinc plated	Sharp	White	1lb	100
5630	HX Screw 1/4" x 2-3/4" - White	1/4" x 2-3/4"	Slotted Hex	Hex Washer	Hi-Lo	White zinc plated	Sharp	White	1lb	100
5631	HX Screw 1/4" x 3-1/2" - White	1/4" x 3-1/2"	Slotted Hex	Hex Washer	Hi-Lo	White zinc plated	Sharp	White	1lb	100
5632	HX Screw 3/16" x 1-1/4" - White	3/16" x 1-1/4"	Slotted Hex	Hex Washer	Hi-Lo	White zinc plated	Sharp	White	1lb	100
5633	HX Screw 3/16" x 1-3/4" - White	3/16" x 1-3/4"	Slotted Hex	Hex Washer	Hi-Lo	White zinc plated	Sharp	White	1lb	100
5634	HX Screw 3/16" x 2-1/4" - White	3/16" x 2-1/4"	Slotted Hex	Hex Washer	Hi-Lo	White zinc plated	Sharp	White	1lb	100
5635	HX Screw 3/16" x 2-3/4" - White	3/16" x 2-3/4"	Slotted Hex	Hex Washer	Hi-Lo	White zinc plated	Sharp	White	1lb	100
5636	HX Screw 3/16" x 3-1/2" - White	3/16" x 3-1/2"	Slotted Hex	Hex Washer	Hi-Lo	White zinc plated	Sharp	White	1lb	100
5627-5	HX Screw 1/4" x 1-1/4" - White	1/4" x 1-1/4"	Slotted Hex	Hex Washer	Hi-Lo	White zinc plated	Sharp	White	5lb	50
5628-5	HX Screw 1/4" x 1-3/4" - White	1/4" x 1-3/4"	Slotted Hex	Hex Washer	Hi-Lo	White zinc plated	Sharp	White	5lb	50
5629-5	HX Screw 1/4" x 2-1/4" - White	1/4" x 2-1/4"	Slotted Hex	Hex Washer	Hi-Lo	White zinc plated	Sharp	White	5lb	50
5630-5	HX Screw 1/4" x 2-3/4" - White	1/4" x 2-3/4"	Slotted Hex	Hex Washer	Hi-Lo	White zinc plated	Sharp	White	5lb	50
5631-5	HX Screw 1/4" x 3-1/2" - White	1/4" x 3-1/2"	Slotted Hex	Hex Washer	Hi-Lo	White zinc plated	Sharp	White	5lb	50
5632-5	HX Screw 3/16" x 1-1/4" - White	3/16" x 1-1/4"	Slotted Hex	Hex Washer	Hi-Lo	White zinc plated	Sharp	White	5lb	50
5633-5	HX Screw 3/16" x 1-3/4" - White	3/16" x 1-3/4"	Slotted Hex	Hex Washer	Hi-Lo	White zinc plated	Sharp	White	5lb	50
5634-5	HX Screw 3/16" x 2-1/4" - White	3/16" x 2-1/4"	Slotted Hex	Hex Washer	Hi-Lo	White zinc plated	Sharp	White	5lb	50
5635-5	HX Screw 3/16" x 2-3/4" - White	3/16" x 2-3/4"	Slotted Hex	Hex Washer	Hi-Lo	White zinc plated	Sharp	White	5lb	50
5636-5	HX Screw 3/16" x 3-1/2" - White	3/16" x 3-1/2"	Slotted Hex	Hex Washer	Hi-Lo	White zinc plated	Sharp	White	5lb	50
5627-25	HX Screw 1/4" x 1-1/4" - White	1/4" x 1-1/4"	Slotted Hex	Hex Washer	Hi-Lo	White zinc plated	Sharp	White	25lb	50
5628-25	HX Screw 1/4" x 1-3/4" - White	1/4" x 1-3/4"	Slotted Hex	Hex Washer	Hi-Lo	White zinc plated	Sharp	White	25lb	50
5629-25	HX Screw 1/4" x 2-1/4" - White	1/4" x 2-1/4"	Slotted Hex	Hex Washer	Hi-Lo	White zinc plated	Sharp	White	25lb	50
5630-25	HX Screw 1/4" x 2-3/4" - White	1/4" x 2-3/4"	Slotted Hex	Hex Washer	Hi-Lo	White zinc plated	Sharp	White	25lb	50
5631-25	HX Screw 1/4" x 3-1/2" - White	1/4" x 3-1/2"	Slotted Hex	Hex Washer	Hi-Lo	White zinc plated	Sharp	White	25lb	50
5632-25	HX Screw 3/16" x 1-1/4" - White	3/16" x 1-1/4"	Slotted Hex	Hex Washer	Hi-Lo	White zinc plated	Sharp	White	25lb	50
5633-25	HX Screw 3/16" x 1-3/4" - White	3/16" x 1-3/4"	Slotted Hex	Hex Washer	Hi-Lo	White zinc plated	Sharp	White	25lb	50
5634-25	HX Screw 3/16" x 2-1/4" - White	3/16" x 2-1/4"	Slotted Hex	Hex Washer	Hi-Lo	White zinc plated	Sharp	White	25lb	50
5635-25	HX Screw 3/16" x 2-3/4" - White	3/16" x 2-3/4"	Slotted Hex	Hex Washer	Hi-Lo	White zinc plated	Sharp	White	25lb	50
5636-25	HX Screw 3/16" x 3-1/2" - White	3/16" x 3-1/2"	Slotted Hex	Hex Washer	Hi-Lo	White zinc plated	Sharp	White	25lb	50

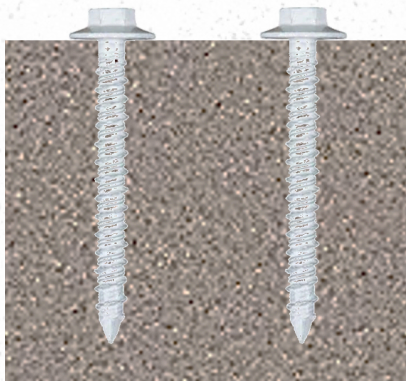
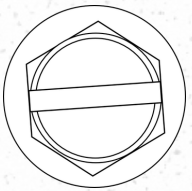
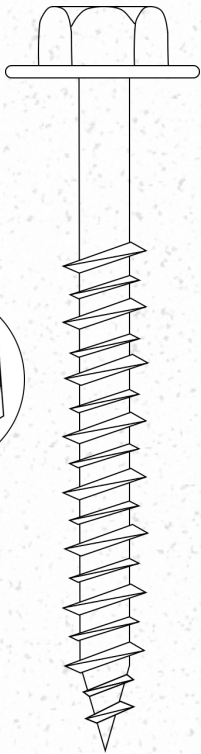

# CONCRETE SCREWS

Finish	Color	For Use On (Material)	Corrosion Resistance
Zinc (electroplated)	White & Zinc Plated	All metals	Good
Phosphate	Black	Metal Stud Gypsum Board Wood Composite Panel	Very Good
Ceramic	Grey	Gutters Metal Roofs Wood Composite Panel	Excellent

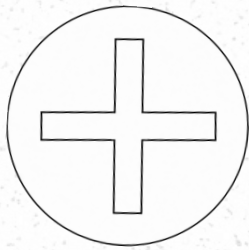
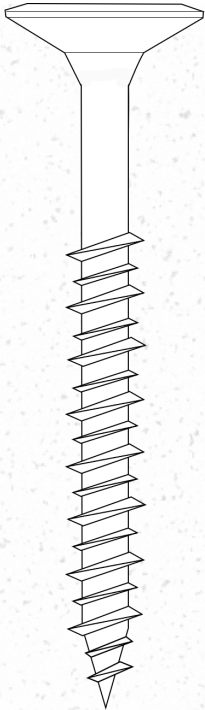

Commercial Code	Name	Size	Head Drives	Head	Thread	Coated	Point	Screw Color	Packaging	MOQ
5637	FH Screw 1/4" x 1-1/4" - White	1/4" x 1-1/4"	Phillips	Countersunk	Hi-Lo	White zinc plated	Sharp	White	100/pcs	100
5638	FH Screw 1/4" x 1-3/4" - White	1/4" x 1-3/4"	Phillips	Countersunk	Hi-Lo	White zinc plated	Sharp	White	100/pcs	100
5639	FH Screw 1/4" x 2-1/4" - White	1/4" x 2-1/4"	Phillips	Countersunk	Hi-Lo	White zinc plated	Sharp	White	100/pcs	100
5640	FH Screw 1/4" x 2-3/4" - White	1/4" x 2-3/4"	Phillips	Countersunk	Hi-Lo	White zinc plated	Sharp	White	100/pcs	100
5641	FH Screw 1/4" x 3-1/2" - White	1/4" x 3-1/2"	Phillips	Countersunk	Hi-Lo	White zinc plated	Sharp	White	100/pcs	100
5642	FH Screw 3/16" x 1-1/4" - White	3/16" x 1-1/4"	Phillips	Countersunk	Hi-Lo	White zinc plated	Sharp	White	100/pcs	100
5643	FH Screw 3/16" x 1-3/4" - White	3/16" x 1-3/4"	Phillips	Countersunk	Hi-Lo	White zinc plated	Sharp	White	100/pcs	100
5644	FH Screw 3/16" x 2-1/4" - White	3/16" x 2-1/4"	Phillips	Countersunk	Hi-Lo	White zinc plated	Sharp	White	100/pcs	100
5645	FH Screw 3/16" x 2-3/4" - White	3/16" x 2-3/4"	Phillips	Countersunk	Hi-Lo	White zinc plated	Sharp	White	100/pcs	100
5646	FH Screw 3/16" x 3-1/2" - White	3/16" x 3-1/2"	Phillips	Countersunk	Hi-Lo	White zinc plated	Sharp	White	100/pcs	100
5637-5	FH Screw 1/4" x 1-1/4" - White	1/4" x 1-1/4"	Phillips	Countersunk	Hi-Lo	White zinc plated	Sharp	White	100/pcs	50
5638-5	FH Screw 1/4" x 1-3/4" - White	1/4" x 1-3/4"	Phillips	Countersunk	Hi-Lo	White zinc plated	Sharp	White	100/pcs	50
5639-5	FH Screw 1/4" x 2-1/4" - White	1/4" x 2-1/4"	Phillips	Countersunk	Hi-Lo	White zinc plated	Sharp	White	100/pcs	50
5640-5	FH Screw 1/4" x 2-3/4" - White	1/4" x 2-3/4"	Phillips	Countersunk	Hi-Lo	White zinc plated	Sharp	White	100/pcs	50
5641-5	FH Screw 1/4" x 3-1/2" - White	1/4" x 3-1/2"	Phillips	Countersunk	Hi-Lo	White zinc plated	Sharp	White	100/pcs	50
5642-5	FH Screw 3/16" x 1-1/4" - White	3/16" x 1-1/4"	Phillips	Countersunk	Hi-Lo	White zinc plated	Sharp	White	100/pcs	50
5643-5	FH Screw 3/16" x 1-3/4" - White	3/16" x 1-3/4"	Phillips	Countersunk	Hi-Lo	White zinc plated	Sharp	White	100/pcs	50
5644-5	FH Screw 3/16" x 2-1/4" - White	3/16" x 2-1/4"	Phillips	Countersunk	Hi-Lo	White zinc plated	Sharp	White	100/pcs	50
5645-5	FH Screw 3/16" x 2-3/4" - White	3/16" x 2-3/4"	Phillips	Countersunk	Hi-Lo	White zinc plated	Sharp	White	100/pcs	50
5646-5	FH Screw 3/16" x 3-1/2" - White	3/16" x 3-1/2"	Phillips	Countersunk	Hi-Lo	White zinc plated	Sharp	White	100/pcs	50
5637-25	FH Screw 1/4" x 1-1/4" - White	1/4" x 1-1/4"	Phillips	Countersunk	Hi-Lo	White zinc plated	Sharp	White	100/pcs	50
5638-25	FH Screw 1/4" x 1-3/4" - White	1/4" x 1-3/4"	Phillips	Countersunk	Hi-Lo	White zinc plated	Sharp	White	100/pcs	50
5639-25	FH Screw 1/4" x 2-1/4" - White	1/4" x 2-1/4"	Phillips	Countersunk	Hi-Lo	White zinc plated	Sharp	White	100/pcs	50
5640-25	FH Screw 1/4" x 2-3/4" - White	1/4" x 2-3/4"	Phillips	Countersunk	Hi-Lo	White zinc plated	Sharp	White	100/pcs	50
5641-25	FH Screw 1/4" x 3-1/2" - White	1/4" x 3-1/2"	Phillips	Countersunk	Hi-Lo	White zinc plated	Sharp	White	100/pcs	50
5642-25	FH Screw 3/16" x 1-1/4" - White	3/16" x 1-1/4"	Phillips	Countersunk	Hi-Lo	White zinc plated	Sharp	White	100/pcs	50
5643-25	FH Screw 3/16" x 1-3/4" - White	3/16" x 1-3/4"	Phillips	Countersunk	Hi-Lo	White zinc plated	Sharp	White	100/pcs	50
5644-25	FH Screw 3/16" x 2-1/4" - White	3/16" x 2-1/4"	Phillips	Countersunk	Hi-Lo	White zinc plated	Sharp	White	100/pcs	50
5645-25	FH Screw 3/16" x 2-3/4" - White	3/16" x 2-3/4"	Phillips	Countersunk	Hi-Lo	White zinc plated	Sharp	White	100/pcs	50
5646-25	FH Screw 3/16" x 3-1/2" - White	3/16" x 3-1/2"	Phillips	Countersunk	Hi-Lo	White zinc plated	Sharp	White	100/pcs	50